

# 83,279 SF

Industrial Space For Lease



## Prologis Mid Counties Distribution Center



6545 Caballero Blvd.  
Buena Park, CA 90620

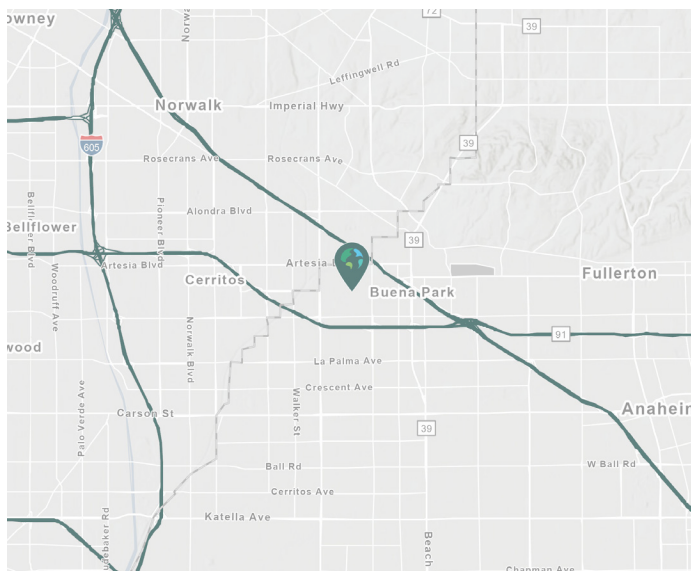

### LOCATION

- Excellent Corporate Image
- Superior Location to the 5 and 91 Freeway Access

### FACILITY

- 83,279 SF Available
- 18,265 SF Total Office
- 30' Ceiling Clearance
- ESFR Sprinklers
- 7 Dock Positions
- 1 Drive-In Door
- Power: 1,200A (verify)
- 120 Total Parking Spaces

### ADVANTAGES AND AMENITIES

- Access to the Prologis Essentials platform, which includes:
  - [Operations Essentials](#)
  - [Energy Essentials](#)
  - [Workforce Essentials](#)
  - [Mobility Essentials](#)
  - [Digital Essentials](#)

Your single-source service for efficient move-in and operations: [prologisessentials.com](https://www.prologisessentials.com)

# 83,279 SF

## Industrial Space For Lease



# Prologis Mid Counties Distribution Center

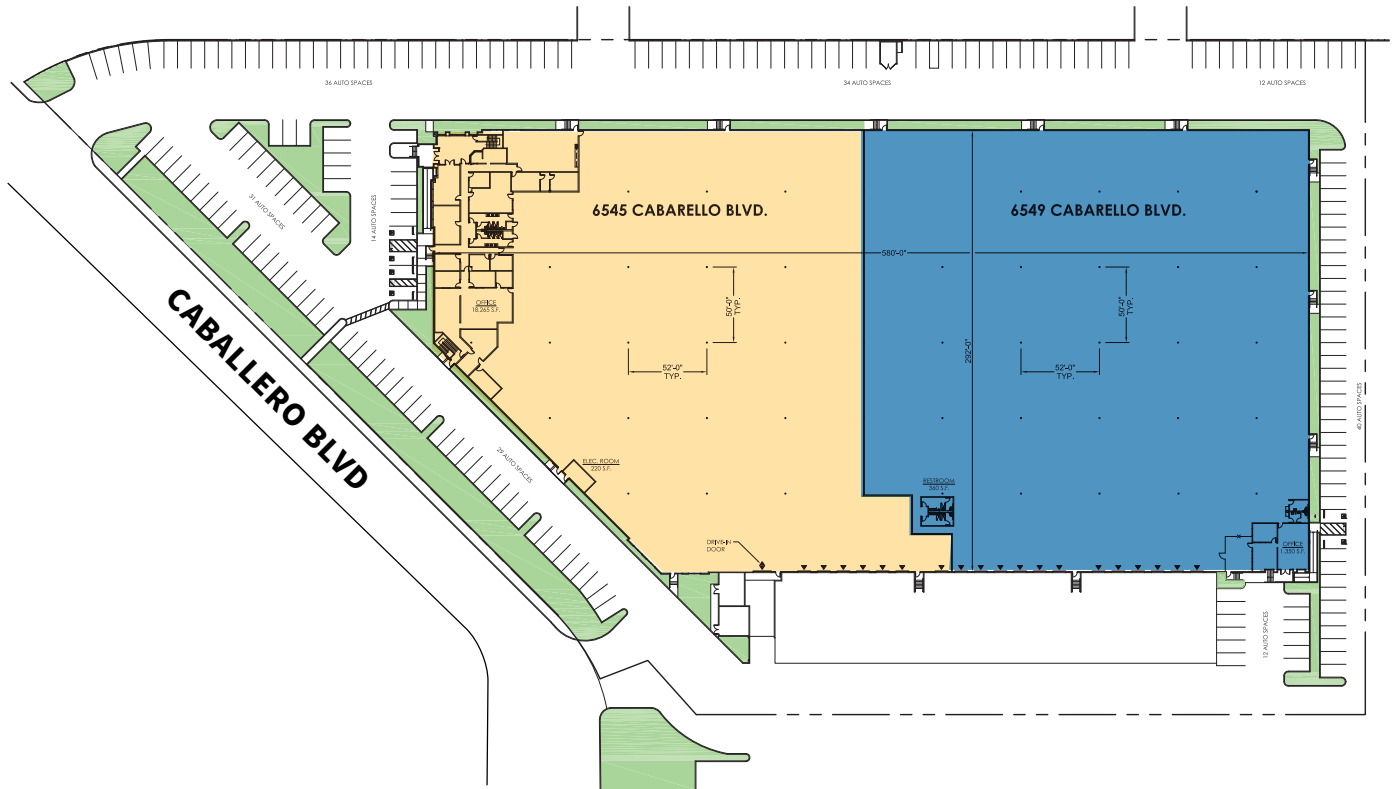

Available Leased



### LAREM

Matt Ginocchio  
CalDRE License #01777208  
mginocchio@lareminc.com  
ph +1 310 436 6483  
cell +1 562 505 6554  
165 Savarona Way  
Carson, CA 90746 USA

### LAREM

Jay Jasaitis  
CalDRE License #00865169  
jjasaitis@lareminc.com  
ph +1 310 436 6487  
cell +1 310 930 7442  
165 Savarona Way  
Carson, CA 90746 USA

### LAREM

Colin Lancaster  
CalDRE License # 02197733  
clancaster@lareminc.com  
ph +1 310 436 6488  
cell +1 310 704 4003  
165 Savarona Way  
Carson, CA 90746 USA

### LAREM

Dimitri Petrakis  
CalDRE License #02208946  
dpetrakis@lareminc.com  
ph +1 310 620 8770  
cell +1 510 468 2075  
165 Savarona Way  
Carson, CA 90746 USA

### Prologis

Parker Hutchison  
CalDRE License #01875578  
phutchison@prologis.com  
ph +1 562 345 9209  
17777 Center Court Dr N  
Ste 100  
Cerritos, CA 90703 USA

**Your single-source service for efficient move-in and operations: [prologisessentials.com](https://www.prologisessentials.com)**

No warranty or representation, expressed or implied, is made as to the accuracy of the information contained herein, and same is submitted subject to error and omissions.