



FOR LEASE

18120 S. Broadway, Unit A, Carson, CA 90248

18,400 SF Industrial Unit

\$1.93/SF Industrial Gross + CAM



FEATURES

Available Square Footage	18,400
Land Square Footage	Part of Larger
Total Office	1,767
Parking	30
Dimensions	92' x 200'
Loading	2 (12' x 16') Ground Level Doors 3 (Truck Well) Dock High Positions
Minimum Ceiling Clearance	18'
Power	200 Amps, 240/240, 3P, 4W
Sprinklers	Yes
Year Built	1957 / R 15
Construction	Concrete Tilt-Up
Zoning	MH*

HIGHLIGHTS

Prominent Street Presence
189 Foot Truck Turning Radius
Large Shared Concrete Yard Area
Immediate Freeway Access
CAM: \$.07/SF
Available: December 1, 2023

ACCESSIBILITY

MILES TO

Los Angeles International Airport	9.5
Long Beach Airport	8.0
Los Angeles & Long Beach Ports (both)	8.0
Intermodal Container Transfer Facility	7.5

IMMEDIATE ACCESS TO

405, 110, 710, and 91 Freeways



DIMITRI PETRAKIS

Cal DRE Lic# 02208946

310.620.8770

dpetrakis@lareminc.com



MATT GINOCCHIO

Cal DRE Lic# 01777208

310.436.6483

mginocchio@lareminc.com



ED WHITTEMORE

Cal DRE Lic# 00935219

310.436.6482

ewhittemore@lareminc.com

310.719.1585 // www.lareminc.com
165 Savarona Way, Carson, California 90746

TRUSTED INDUSTRIAL REAL ESTATE SOLUTIONS SINCE 1993

The information above has been obtained from sources believed reliable. While we do not doubt its accuracy, we have not verified it and make no guarantee, warranty or representation about it. It is your responsibility to independently confirm its accuracy and completeness. Any projections, options, assumptions or estimates used are for example only and do not represent the current or future performance of the property. The value of this transaction to you depends on tax and other factors which should be evaluated by your tax, financial and legal advisors. You and your advisors should conduct a careful, independent investigation of the property to determine to your satisfaction the suitability of the property for your needs.



FOR LEASE

18120 S. Broadway, Unit A, Carson, CA 90248

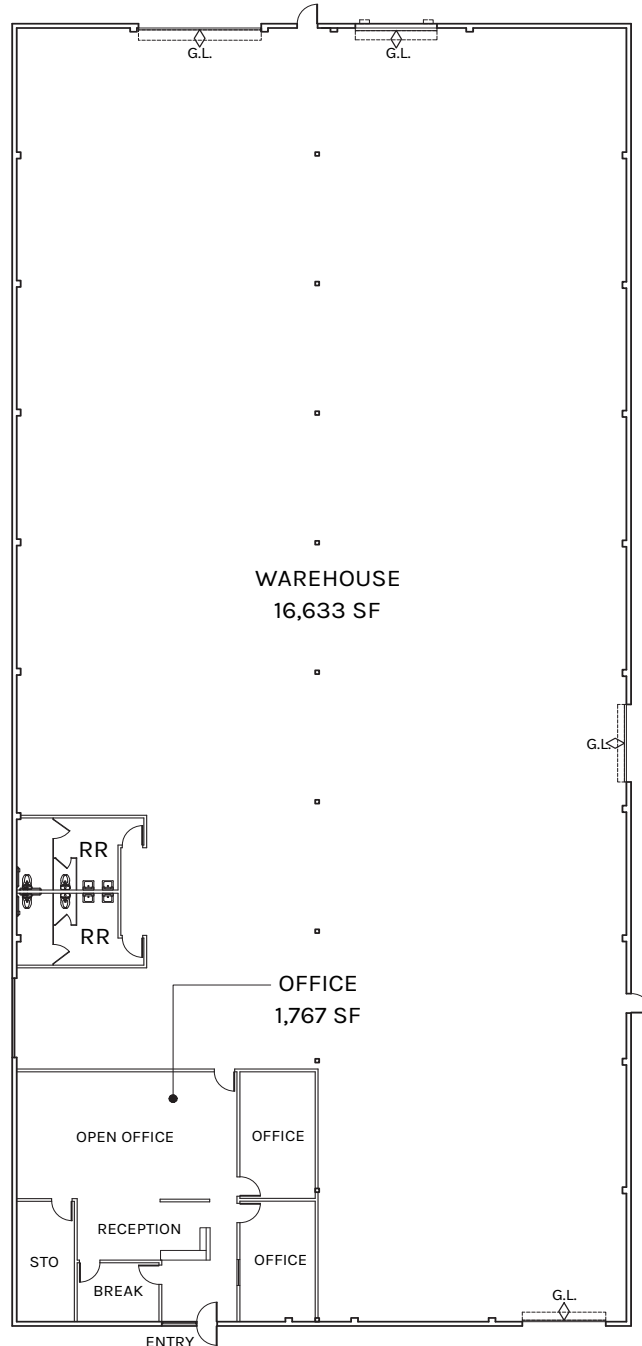

**Rexford
Industrial**

PLAN LAYOUT SUBJECT TO FIELD CONDITIONS AND MAY DIFFER FROM PLAN AS SHOWN. ALL INFORMATION PRESENTED ON THIS DRAWING IS PRESUMED TO BE ACCURATE, HOWEVER TENANT SHOULD VERIFY PERTINENT INFORMATION PRIOR TO COMMITTING TO A LEASE ANY FURNITURE OR APPLIANCES SHOWN ON PLAN ARE FOR CONCEPT ONLY AND WILL BE TENANT PROVIDED.

The information above has been obtained from sources believed reliable. While we do not doubt its accuracy, we have not verified it and make no guarantee, warranty or representation about it. It is your responsibility to independently confirm its accuracy and completeness. Any projections, options, assumptions or estimates used are for example only and do not represent the current or future performance of the property. The value of this transaction to you depends on tax and other factors which should be evaluated by your tax, financial and legal advisors. You and your advisors should conduct a careful, independent investigation of the property to determine to your satisfaction the suitability of the property for your needs.

310.719.1585 // www.lareminc.com
165 Savarona Way, Carson, California 90746

TRUSTED INDUSTRIAL REAL ESTATE SOLUTIONS SINCE 1993