



# FOR LEASE

3131 E Maria Street, Rancho Dominguez, CA 90221

**AVAILABLE 66,075 SF Warehouse**

**\$1.25/SF Gross + OPEX \$.06/SF**



## FEATURES

Available Square Footage	66,075
Land Square Footage	108,465
Total Office	6,742
Parking	70
Loading	1 (8' x 10') GL Door (via ramp) 12 (8' x 10') DH Doors
Minimum Ceiling Clearance	21' - 23'
Power	600 Amps, 277-480V, 3P, 4W
Sprinklers	Yes
Year Built	1969
Construction	Brick
Zoning	CAMH

## HIGHLIGHTS

Desirable Unincorporated LA County Location  
Fenced Truck Court  
12 Dock High Loading Doors  
Office Space can be Reduced  
Possession 12/01/2025  
Can be leased with 3145 Maria Street – 23,886 SF Building  
Opex: \$.06/SF

## ACCESSIBILITY

### MILES TO

Los Angeles International Airport	18.7
Long Beach Airport	6.7
Los Angeles & Long Beach Ports (both)	11.2

### IMMEDIATE ACCESS TO

710 and 91 Freeways  
Alameda Corridor



### WESLEY BABI

Cal DRE Lic# 01822752

📞 310.436.6481

✉️ wbabi@lareminc.com



### JAY JASAITIS

Cal DRE Lic# 00865169

📞 310.436.6487

✉️ jjasaitis@lareminc.com

📞 310.719.1585 // [www.lareminc.com](http://www.lareminc.com)  
165 Savarona Way, Carson, California 90746

**TRUSTED INDUSTRIAL REAL ESTATE SOLUTIONS SINCE 1993**

The information above has been obtained from sources believed reliable. While we do not doubt its accuracy, we have not verified it and make no guarantee, warranty or representation about it. It is your responsibility to independently confirm its accuracy and completeness. Any projections, options, assumptions or estimates used are for example only and do not represent the current or future performance of the property. The value of this transaction to you depends on tax and other factors which should be evaluated by your tax, financial and legal advisors. You and your advisors should conduct a careful, independent investigation of the property to determine to your satisfaction the suitability of the property for your needs.



# FOR LEASE

3131 E Maria Street, Rancho Dominguez, CA 90221

## FLOOR PLAN

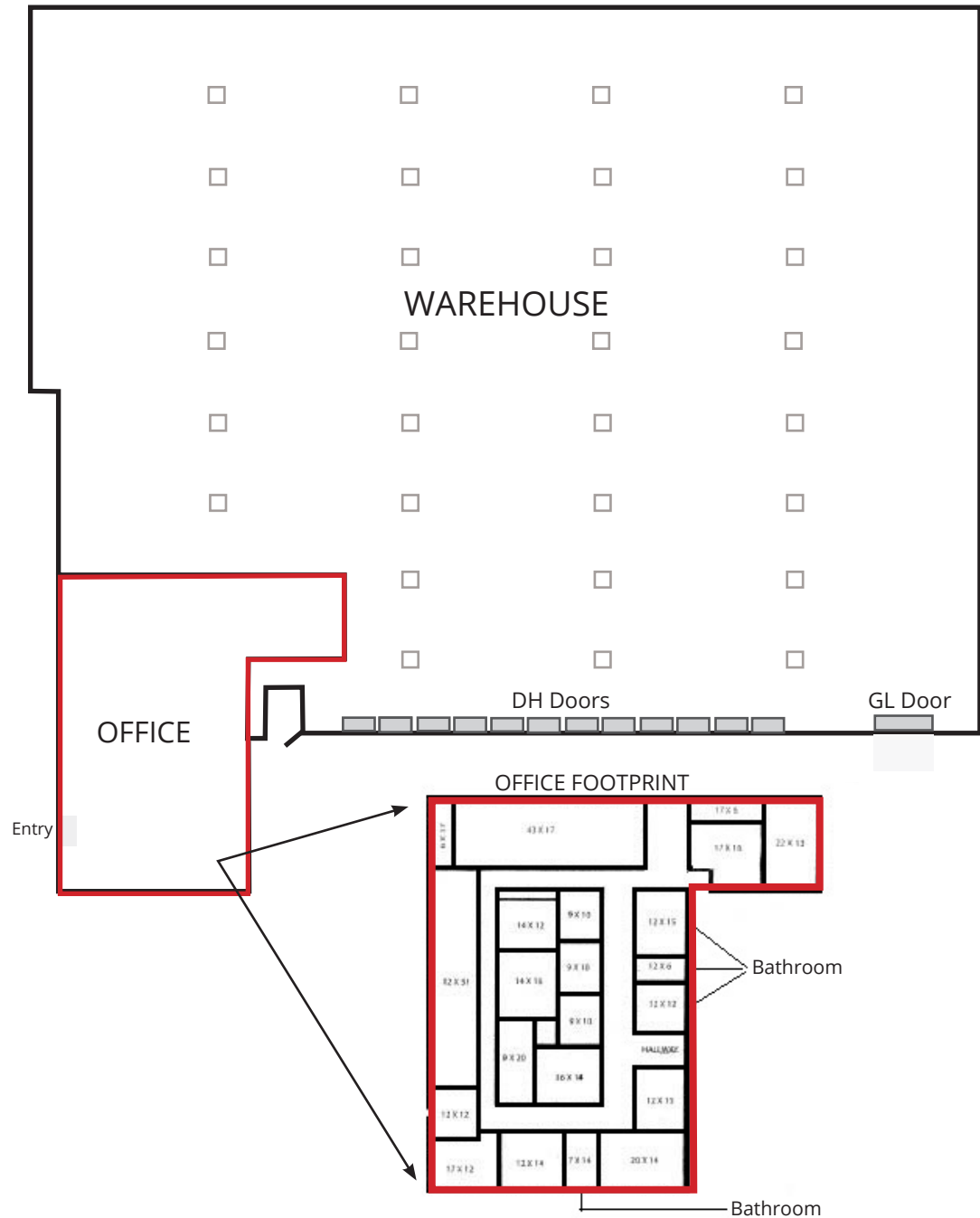

The information above has been obtained from sources believed reliable. While we do not doubt its accuracy, we have not verified it and make no guarantee, warranty or representation about it. It is your responsibility to independently confirm its accuracy and completeness. Any projections, options, assumptions or estimates used are for example only and do not represent the current or future performance of the property. The value of this transaction to you depends on tax and other factors which should be evaluated by your tax, financial and legal advisors. You and your advisors should conduct a careful, independent investigation of the property to determine to your satisfaction the suitability of the property for your needs.



310.719.1585 // [www.lareminc.com](http://www.lareminc.com)

165 Savarona Way, Carson, California 90746

TRUSTED INDUSTRIAL REAL ESTATE SOLUTIONS SINCE 1993