



# FOR SUBLEASE

19914 S Via Baron, Rancho Dominguez, CA 90220

**Available 234,771 SF Building**

**\$TBD**



## FEATURES

Available Square Footage	234,771
Land Square Footage	493,535
Office Square Footage	8,462
Loading	34 Dock High Positions 1 Ground Level Ramp
Minimum Ceiling Clearance	23'
Car Parking	64 Spaces
Container Parking	132 Spaces
Power	1600A, 277/480, 3P, 4W
Sprinklers	ESFR
Year Built	1973

## HIGHLIGHTS

Sublease Through: 7/31/2030  
Operating Expenses & Taxes: \$.25/SF  
Large Fenced Yard

## ACCESSIBILITY

### MILES TO

Los Angeles Airport (LAX)	12
Los Angeles & Long Beach Ports (both)	18
Alameda Corridor	7

### IMMEDIATE ACCESS TO

710, 91, and 110 Freeways



### ED WHITTEMORE

Cal DRE Lic# 00935219

**310.436.6482**

ewhittemore@lareminc.com



### COLIN LANCASTER

Cal DRE Lic# 02197733

**310.436.6488**

clancaster@lareminc.com



### DIMITRI PETRAKIS

Cal DRE Lic# 02208946

**310.620.8770**

dpetrakis@lareminc.com

310.719.1585 // [www.lareminc.com](http://www.lareminc.com)  
165 Savarona Way, Carson, California 90746

**TRUSTED INDUSTRIAL REAL ESTATE SOLUTIONS SINCE 1993**

The information above has been obtained from sources believed reliable. While we do not doubt its accuracy, we have not verified it and make no guarantee, warranty or representation about it. It is your responsibility to independently confirm its accuracy and completeness. Any projections, options, assumptions or estimates used are for example only and do not represent the current or future performance of the property. The value of this transaction to you depends on tax and other factors which should be evaluated by your tax, financial and legal advisors. You and your advisors should conduct a careful, independent investigation of the property to determine to your satisfaction the suitability of the property for your needs.



# FOR SUBLEASE

19914 S Via Baron, Rancho Dominguez, CA 90220

## SITE PLAN

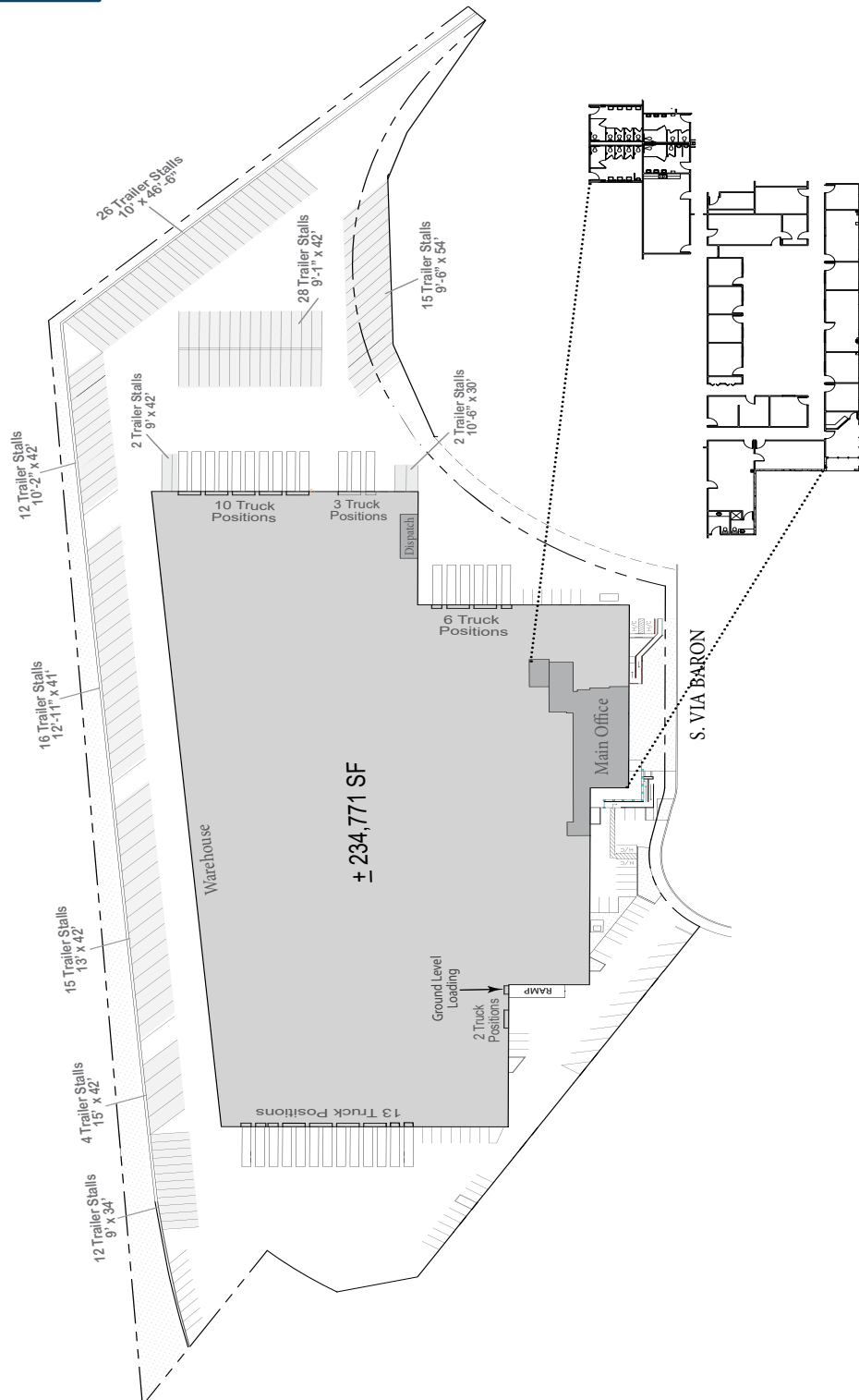

S. VIA BARON

The information above has been obtained from sources believed reliable. While we do not doubt its accuracy, we have not verified it and make no guarantee, warranty or representation about it. It is your responsibility to independently confirm its accuracy and completeness. Any projections, options, assumptions or estimates used are for example only and do not represent the current or future performance of the property. The value of this transaction to you depends on tax and other factors which should be evaluated by your tax, financial and legal advisors. You and your advisors should conduct a careful, independent investigation of the property to determine to your satisfaction the suitability of the property for your needs.



310.719.1585 // [www.lareminc.com](http://www.lareminc.com)

165 Savarona Way, Carson, California 90746

TRUSTED INDUSTRIAL REAL ESTATE SOLUTIONS SINCE 1993